

# Quick Suctioning Immersion Pumps

## TGL/SGL331...333



Hoogeijndsestraat 5  
NL - 5447 PD Rijkevoort  
Nederland  
T: +31 (0) 485 - 371318  
F: +31 (0) 485 - 371918

Axial/semi-open impellers

### TGL331

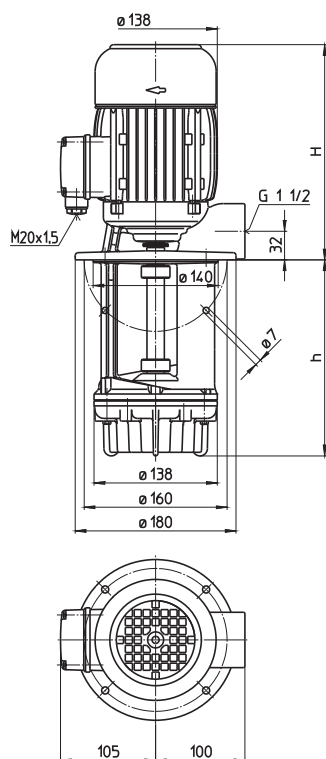

### SGL331...333

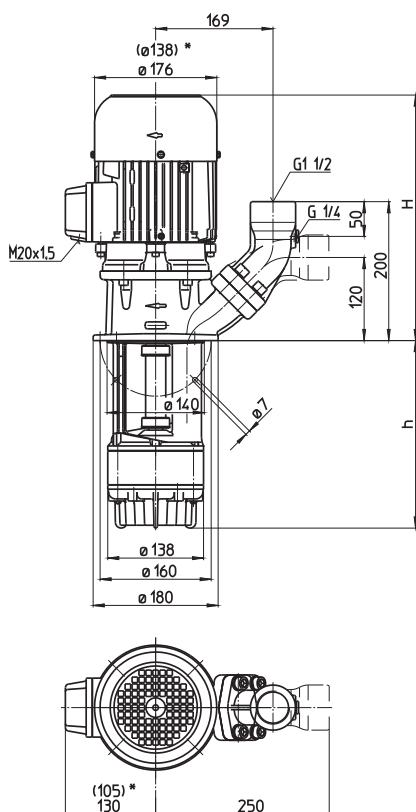

\*) Dimensions for SGL331

| Type              | Vol. del. at manom. del. head<br>l/min /m | Height<br>H mm | Depth of immersion<br>h mm | Weight<br>kg | Power<br>kW | Voltage<br>3~<br>V | Fre-<br>quen-<br>cy<br>Hz | Current<br>A | Speed<br>1/min |
|-------------------|---|----------------|----------------------------|--------------|-------------|--------------------|---------------------------|--------------|----------------|
| <b>TGL331/140</b> | 200/5                                     | 264            | 140                        | 16.0         | 0.85        | 220-240            | 50                        | 3.64         | 2850           |
| 220               |   |                | 220                        | 17.0         |             |                    |                           |              |                |
| 290               |   |                | 290                        | 17.5         |             |                    |                           |              |                |
| 370               |   |                | 370                        | 18.5         | 0.98        | 460                | 60                        | 2            | 3450           |
| 460               |   |                | 460                        | 20.0         |             |                    |                           |              |                |
| 570               |   |                | 570                        | 21.0         |             |                    |                           |              |                |
| <b>SGL331/140</b> | 200/5                                     | 334            | 140                        | 22           | 0.85        | 220-240            | 50                        | 3.64         | 2850           |
| 220               |   |                | 220                        | 23           |             |                    |                           |              |                |
| 290               |   |                | 290                        | 24           |             |                    |                           |              |                |
| 370               |   |                | 370                        | 25           | 0.98        | 460                | 60                        | 2            | 3450           |
| 460               |   |                | 460                        | 27           |             |                    |                           |              |                |
| 570               |   |                | 570                        | 28           |             |                    |                           |              |                |
| 770               |   |                | 770                        | 35           |             |                    |                           |              |                |
| 920               |   |                | 920                        | 37           |             |                    |                           |              |                |
|                   |   |                |                            |              |             |                    |                           |              |                |
| <b>SGL332/190</b> | 200/12                                    | 406            | 190                        | 34           | 1.7         | 220-240            | 50                        | 6.24         | 2890           |
| 270               |   |                | 270                        | 35           |             |                    |                           |              |                |
| 340               |   |                | 340                        | 36           |             |                    |                           |              |                |
| 420               |   |                | 420                        | 37           | 1.95        | 460                | 60                        | 3.5          | 3480           |
| 510               |   |                | 510                        | 38           |             |                    |                           |              |                |
| 620               |   |                | 620                        | 40           |             |                    |                           |              |                |
| 820               |   |                | 820                        | 47           |             |                    |                           |              |                |
| 970               |   |                | 970                        | 49           |             |                    |                           |              |                |
|                   |   |                |                            |              |             |                    |                           |              |                |
| <b>SGL333/240</b> | 200/19                                    | 439            | 240                        | 40           | 2.2         | 220-240            | 50                        | 7.8          | 2890           |
| 320               |   |                | 320                        | 41           |             |                    |                           |              |                |
| 390               |   |                | 390                        | 42           |             |                    |                           |              |                |
| 470               |   |                | 470                        | 43           | 2.55        | 460                | 60                        | 4.4          | 3480           |
| 560               |   |                | 560                        | 45           |             |                    |                           |              |                |
| 670               |   |                | 670                        | 47           |             |                    |                           |              |                |
| 870               |   |                | 870                        | 53           |             |                    |                           |              |                |
| 1020              |   |                | 1020                       | 55           |             |                    |                           |              |                |

**Quick Suctioning Immersion Pumps**

series TGL/SGL equipped with the patented "BRINKMANN's Suction De-aeration System" are excellently suited to pumping **extremely air entrained fluids** (grinding oils) as they occur in **high-speed grinding**.

The quick suctioning immersion pumps reach stable working conditions as soon as the liquid level reaches the suction inlet.

The SGL serie offers a (SAE) flange with pressure gauge connection port. The flange can be rotated for either horizontal or vertical pipe connections.

**Applications**

- Types of fluid
  - coolants
  - cooling/cutting oils
  - grinding oils
- Kinematic viscosity  
...45 mm<sup>2</sup>/s (45 cSt)
- Pumping temperature  
0...80° C

**Construction**

- |                 |            |
|-----------------|------------|
| Pump body       | cast iron  |
| Cover           | cast iron  |
| Impeller axial  | cast steel |
| Impeller radial | cast steel |
| Shaft           | steel      |

