

SBA601S...604S

Axial/semi-open impellers



60 Hz

SBA601S...604S

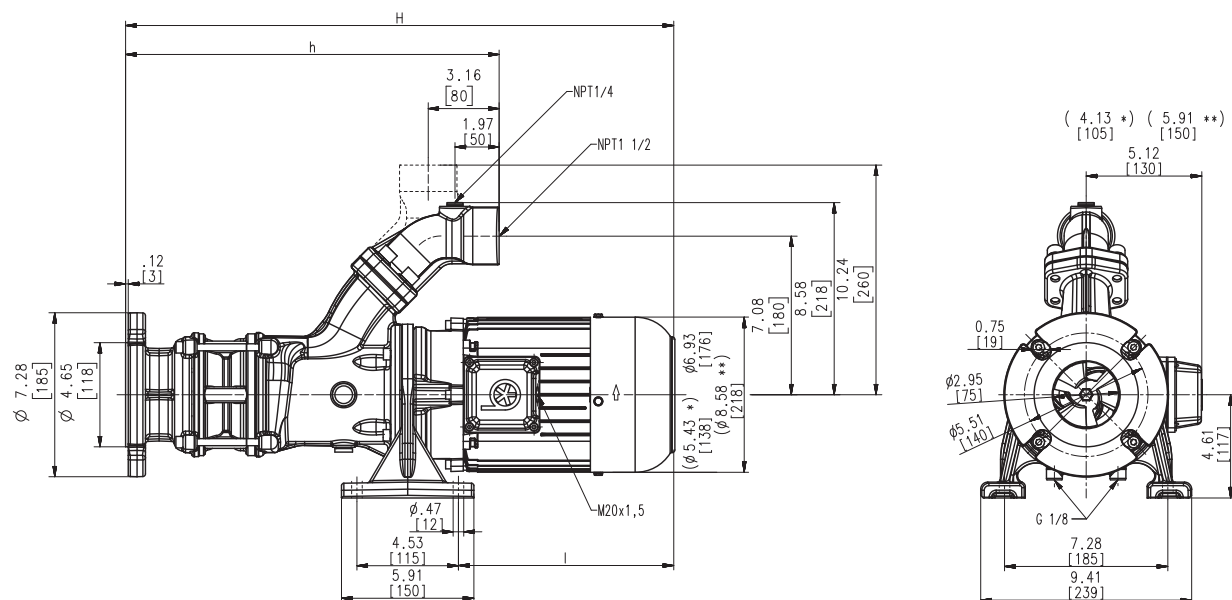

Dimensions in Inches / mm

*) Dimensions SBA601S

***) Dimensions SBA603S, 604S

Type	Flow at head	Dimensions				Length		Weight		Power	Voltage 3 ~	Fre- quen- cy	Current	Speed
	GPM /Feet l/min /m	H inch	H mm	h inch	h mm	l Inch	l mm	Lbs	kg					
SBA601S	110/18 440/5	20.6	524	14.2	360	8.3	211	70.6	32	1.7 1.27	230 460	60 60	4.8 2.4	3440 3440
SBA602S	110/46 440/13	26.2	666	16.7	424	11.4	289	101.4	46	3.4 2.55	230 460	60 60	8.8 4.4	3480 3480
SBA603S	110/76 440/21	30.3	769	19.2	488	12.9	328	134.5	61	5.1 3.8	230 460	60 60	12.8 6.4	3520 3520
SBA604S	110/90 440/25	34.0	863	21.7	552	14.1	358	154.4	70	7.7 5.75	230 460	60 60	19.0 9.5	3520 3520



Horizontal End-Suction Pumps

are centrifugal inline pumps with a compact design where the impeller is mounted onto the extended motor shaft.

These pumps are not self-priming and must be gravity fed. All pumps are equipped with a single mechanical seal.

Upon request a second mechanical seal is available to allow for dry-running (-GD).

This pump series is designed for horizontal installations next to a tank and for pumping **air entrained coolant** fluids, such as **water-soluble coolants or cutting oils**, as they occur in **high speed turning, milling or grinding applications**.

The SBA pumps are equipped with the user-friendly **SAE flange** connection which allows for either vertical or horizontal pipe connection and the connection of a pressure gauge with NPT 1/4.

For more information see mechanical features within the technical information section.



Applications

Types of fluid

coolants

cooling/cutting oils

Kinematic viscosity

...200 SSU (...45 mm²/s)

Pumping temperature

30...175 °F (0...80 °C)

Construction

Pump body

cast iron

Cover

cast iron

Impeller axial

cast steel

Impeller radial

cast steel

Shaft

steel

Mechanical seal

SiC

Noise level

SBA601S

65 dBA

SBA602S

69 dBA

SBA603S

72 dBA

SBA604S

74 dBA

