

## Immersion pumps

## Type IMM 63



### Usages:

The pumps are suitable to transfer liquids containing impurities measuring up to 2-3 mm. The hydraulic components, namely the nylon impeller and scroll and the aluminium pump body allow the pumps to be used with water, emulsions and oily substances in general with a maximum viscosity of 3° Engler (21 CST). The temperature of the liquid must not exceed 90° C.

### They are usually used on:

- Machine tools** (milling machines – lathes - drills)
- Glass processing machines** (TRI version)
- Surface treatment systems** (version in cast iron)\*
- Filtration systems**
- Air-conditioning systems**

They should usually be installed on a tank, with a capacity in proportion to the flow rate, at about 4 – 5 cm. from the bottom. It is important to check that the maximum level of the liquid in the tank always remains 3 – 4 cm. lower than the flange (see figure).

In cases where the liquid is particularly dirty, the user is recommended to construct the tank in compartments to allow the dirt to deposit before it is stirred up by the pump.

For other usages you are advised to consult our technical office.

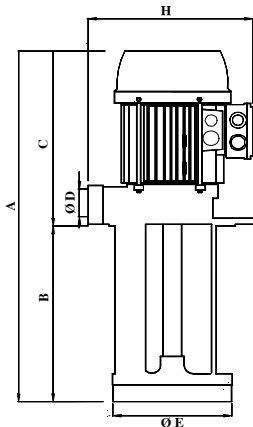

Table of dimensions and weights

TYPE	A mm	B mm	C mm	ØD mm	ØE mm	ØF mm	ØG mm	H mm	ØI mm	ØL mm	Kg.
IMM 63 A	355	150 T	205	3/4"	128	-	180	190	150	9 N. 4	5,00
	405	200 T									5,15
	455	250 T									5,30
	505	300* T									5,45
IMM 63 B	355	150 T	205	3/4"	128	-	180	190	150	9 N. 4	5,50
	405	200 T									5,70
	455	250 T									5,90
	505	300* T									6,05

On request: T = execution TRI \* = cast iron pump body

### Electrical features

Type	KW. Input	Hz. 50		Hz. 60			
		230/400	254-290/440-500	230/400	208-230/440-460	254-277/440-480	318-346/550-600
IMM 63 A	0,30	1,0/0,58	0,76/0,44	1,2/0,7	1,1/0,6	1,0/0,58	0,8/0,45
IMM 63 B	0,40	1,6/0,9	1,2/0,7	1,9/1,1	1,73/1,0	1,6/0,9	1,2/0,7

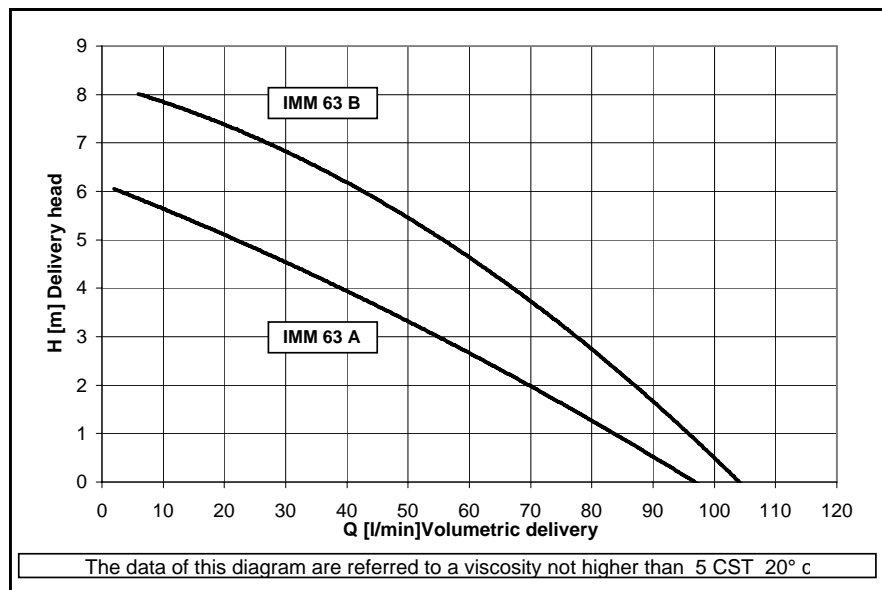
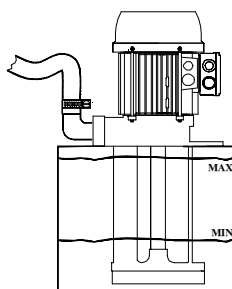
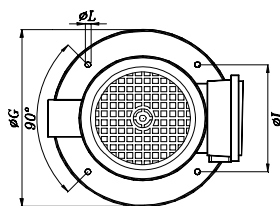

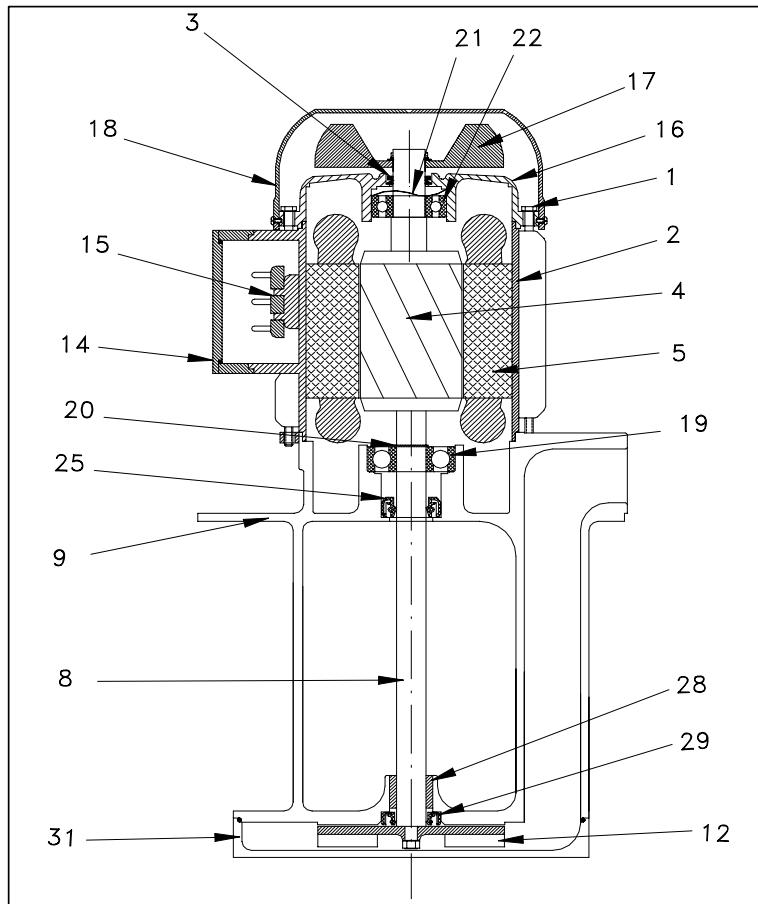

Type	IMM 63A	Type	IMM 63B
<b>Components</b>	<b>Materials</b>	<b>Components</b>	<b>Materials</b>
1 Rod	Steel	1 Rod	Steel
2 Frame	Aluminium	2 Frame	Aluminium
3 V-Ring Ø 16	NBR	3 V-Ring Ø 16	NBR
4 Rotor		4 Rotor	
5 Stator		5 Stator	
8 Shaft	Steel C 40**	8 Shaft	Steel C 40**
9 Pump body	Aluminium*	9 Pump body	Aluminium *
12 Impeller	Nylon	12 Impeller	Nylon
14 Terminal box	Nylon	14 Terminal box	Nylon
15 Terminal block	mm. 40x25 6P	15 Terminal block	mm. 40x25 6P
16 Non-drive end shield	Aluminium	16 Non-drive end shield	Aluminium
17 Fan	Nylon	17 Fan	Nylon
18 Fan cover	Nylon***	18 Fan cover	Nylon***
19 Bearing	6203 ZZ	19 Bearing	6203 ZZ
20 Retaining ring	ø 17	20 Retaining ring	ø 17
21 Spring ring	ø 35	21 Spring ring	ø 35
22 Bearing	6202 ZZ	22 Bearing	6202 ZZ
25 Sealing ring	NBR 17X30X7	25 Sealing ring	NBR 17X30X7
28 Bronze bearing	19X17X15	28 Bronze bearing	19X17X15
29 Sealing ring	NBR 17X25X4	29 Sealing ring	NBR 17X25X4
31 House impeller	Nylon	31 House impeller	Nylon

On request

*	Cast iron G20 - only length mm. 300
**	Aisi 420
***	Sheet